



01 FLOOR PLAN-LEVEL 1
A1-10 1/16" = 1'-0"

SHERMAN HOSPITAL

FLOOR PLAN- LEVEL 1

2021.07.06
PROJECT ADDRESS LINE 1
SHERMAN, TX

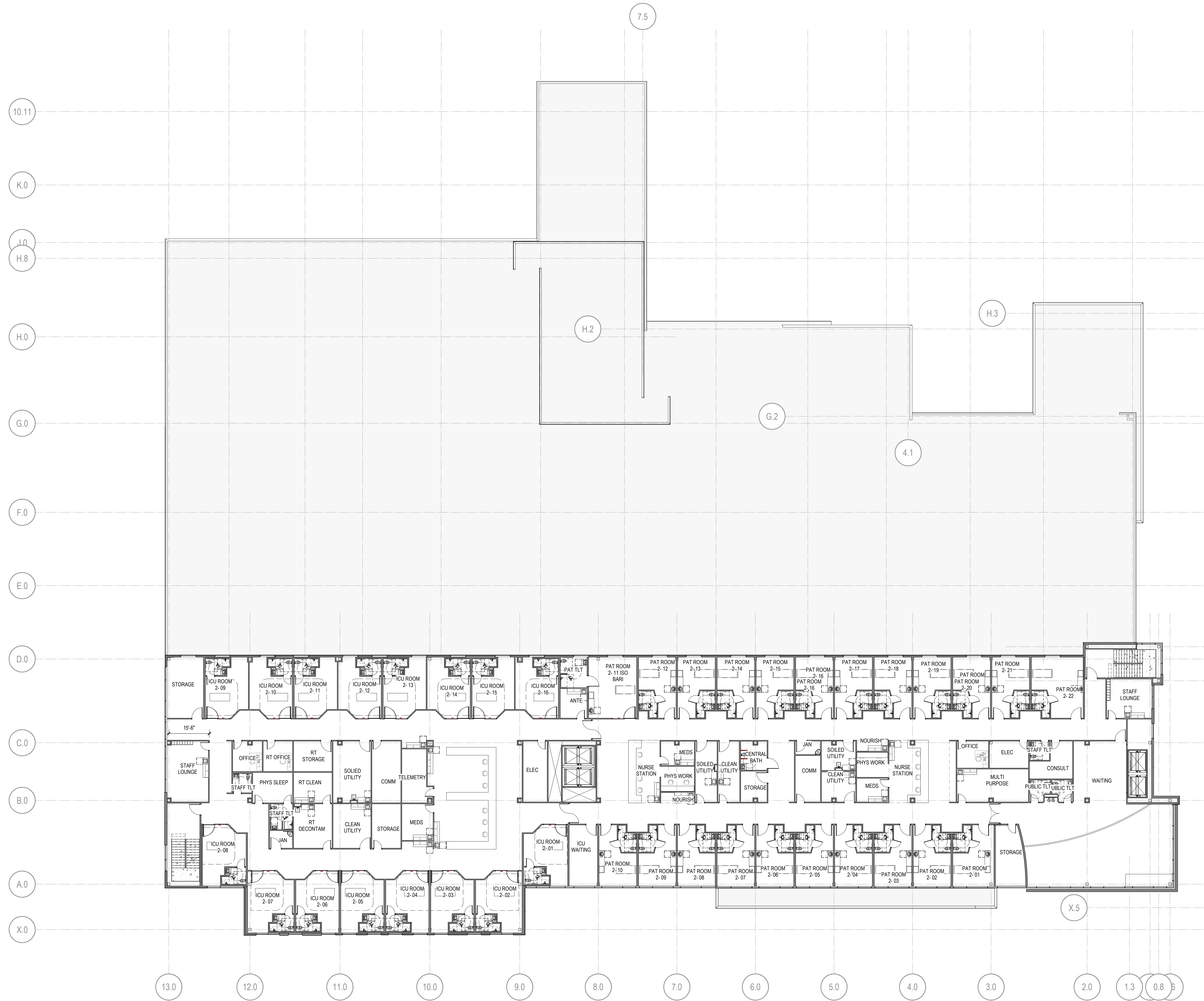

01 FLOOR PLAN- LEVEL 2
 41-20 1/16" = 1'-0"

SHERMAN HOSPITAL

FLOOR PLAN- LEVEL 2

2021.07.08

PROJECT ADDRESS LINE 1
 SHERMAN, TX

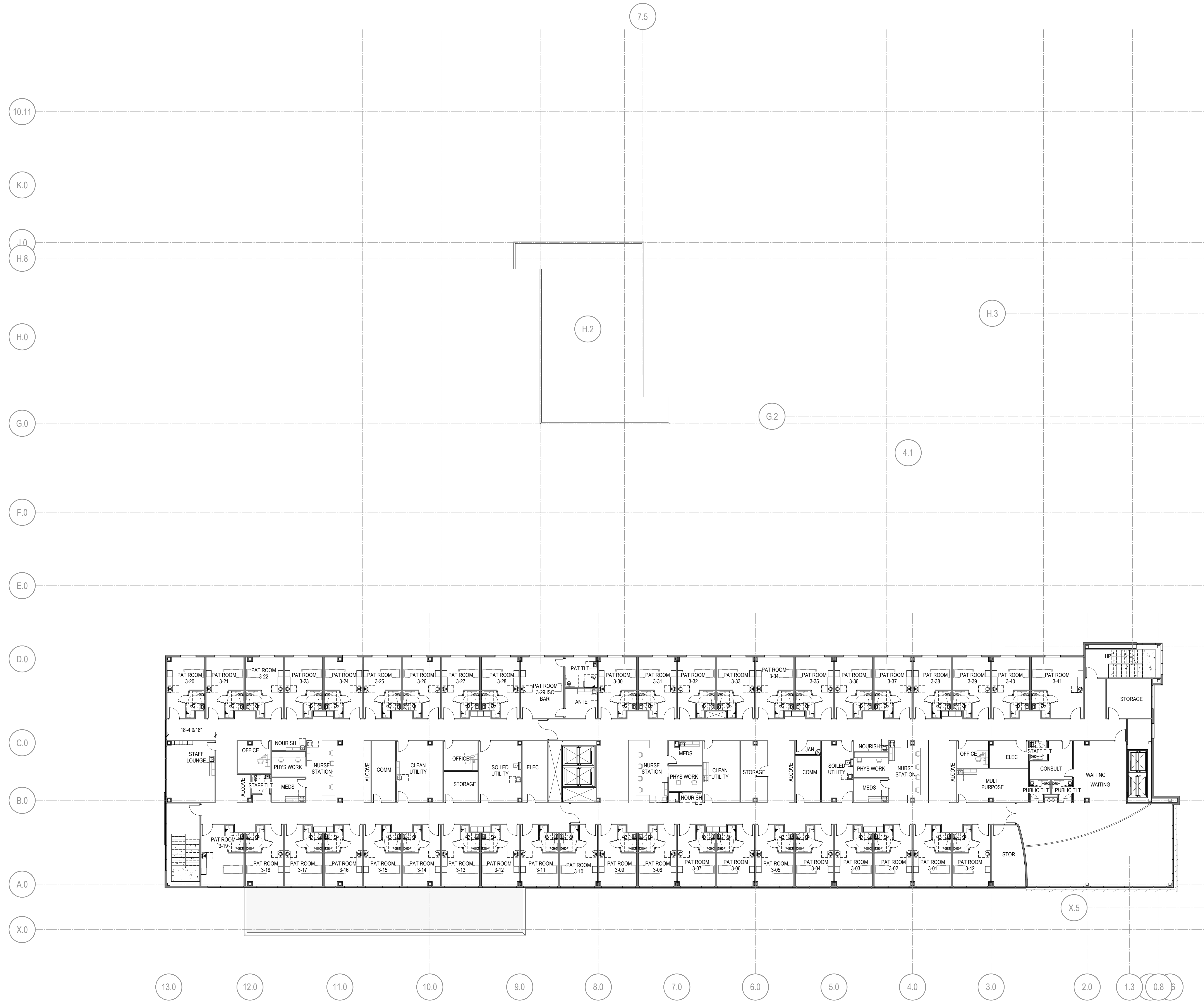

01 FLOOR PLAN- LEVEL 3
 41-30 1/16" = 1'-0"

SHERMAN HOSPITAL

FLOOR PLAN- LEVEL 3

2021.07.08

PROJECT ADDRESS LINE 1
 SHERMAN, TX

APPROXIMATE LOCATION
OF VARIABLE WIDTH
PIPE LINE EASEMENT,
VOL. 4660, PG. 270,
D.R.G.C.T.

SIGN

GAS LINE

(PROPOSED 80' RIGHT-OF-WAY)
CROSSROAD

01 ARCHITECTURAL SITE PLAN
AS-01 1" = 30'-0"

2021.07.08

PROJECT ADDRESS LINE 1
SHERMAN, TX

SHERMAN HOSPITAL

SITE PLAN



ENVIRONMENTS
FOR HEALTH
ARCHITECTURE

888.781.8441 817.226.1917 1217 8th Ave, #301, Fort Worth, TX 76104
© 2021 E4H - Environments For Health, LLC e4harchitecture.com